

COMFORT PACK

**WALL SLEEVE AND ADAPTER
ASSEMBLY INSTRUCTIONS**

**NATIONAL
COMFORT
PRODUCTS**

HEATING & AIR CONDITIONING EQUIPMENT

A Division of National Refrigeration & Air Conditioning Products, Inc.

539 Dunksferry Road • Bensalem, PA 19020 • (215) 244-1400 • 1-800-523-7138 • Fax: (215) 244-9579

WALL SLEEVE PARTS IDENTIFICATION LIST

ITEM	DESCRIPTION	PART NO.	QUANTITY
1	Top Panel	14256146	1
2	Bottom Panel	14256147	1
3	Side Panel	14256148	2
4	Side Mounting Bracket	14256149	2
5	Top Mounting Bracket	14256150	1
6	Bottom Guide	14256151	1
7	Side Guide (Mounted)	14256152	4
8	Gusset	14256153A	2
9	10 x 3/8" Hex HD Screw	14295024	26
10	Steel Rivet (Mounted)	14295025	8
11	Seal (not shown)	14231014	15 ft.
12	Isolation Grommet (not shown)	14293018	5
13	Flat Washer (not shown)	14295005	5
14	14-14, 1 1/4" Sheet Metal Screw (not shown)	14395023	5
15	Assembly Instructions	14299576	1

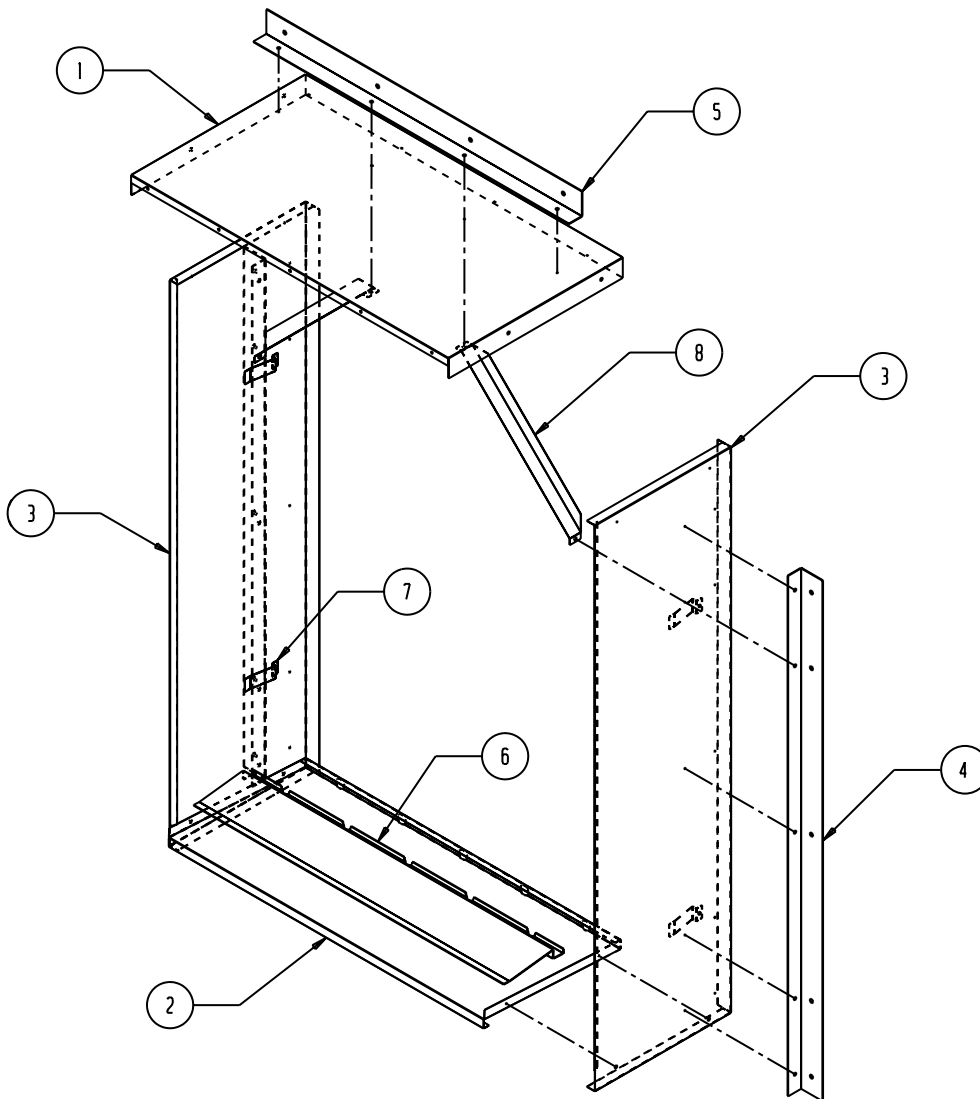

Assembly Instructions

CAUTION: ALWAYS WEAR SAFETY GLASSES WHEN WORKING WITH TOOLS! OVER-TIGHTENING THE SCREWS MAY STRIP THE RETAINING HOLES. READ ALL OF THE ASSEMBLY INSTRUCTIONS STEPS BEFORE PROCEEDING.

1. Identify ALL of the parts shown in the parts list. If any parts are missing, notify the factory for replacement(s).
2. On the top panel and both side panels, the wider flange is to be positioned as the front (outside) surface. Attach one gusset to the inside of the side panel selected for the left side by inserting the screw through the hole in the gusset and using the 1/8" hole located 9 1/4" down from the top flange and 1 1/2" in from the 7/8" front (outside) flange.
3. Attach the other gusset to the inside of the other side panel selected for the right side by inserting the screw through the hole located 9 1/4" down from the top flange and 1 1/2" in from the 7/8" front (outside) flange.
4. Position the top of the right side panel inside the right end of the top panel with the front flanges together. Attach by using two screws through the top panel side flange holes into the right side panel.
5. Position the top of the left side panel inside the left end of the top panel with the front flanges together. Attach by using two screws through the top panel side flange holes into the left side panel.
6. Attach the gussets to the inside of the top panel by placing the screws through the holes in the gussets and attaching them to the top panel using the holes 1" from the front (outside).
7. Attach the bottom panel to the bottom of both side panels using screws through the side panels into the bottom panel.
8. Place the bottom guide on the bottom panel so that the drain holes align.
9. Two sets of holes are provided in the side and top panels for attaching the mounting brackets. Select the set of holes that provide the appropriate spacing for your installation. Attach the top mounting bracket to the outside of the top panel using four screws through the shorter flange of the top mounting bracket into the top panel.
10. For installing the side mounting brackets, select the set of mounting holes in the side panels that matches the distance from the front flange that was used on the top panel in **Step 9**. Install the side mounting brackets to the outside of each side panel using five screws through the shorter flange of each side mounting bracket into each side panel.

11. The Wall Sleeve must be square for the cabinet to slide into it. Position the Wall Sleeve in the opening. After verifying that the Wall Sleeve is square in the opening, attach the Wall Sleeve to the building.
12. After securing the Wall Sleeve to the building, remove the gussets. Caulk all seams including the front corners.
13. Install the isolation grommets into the five holes in the top mounting angle on the Comfort Pack unit.
14. Carefully slide the Comfort Pack unit into the Wall Sleeve so that the front of the unit is in contact with the front flanges of the Wall Sleeve. Put a flat washer onto each 1 1/4" screw and install the five screws through the grommets in the top mounting angle of the Comfort Pack unit into the Wall Sleeve and tighten. Over-tightening the 1 1/4" screws will deform the isolation grommets and reduce their effectiveness.

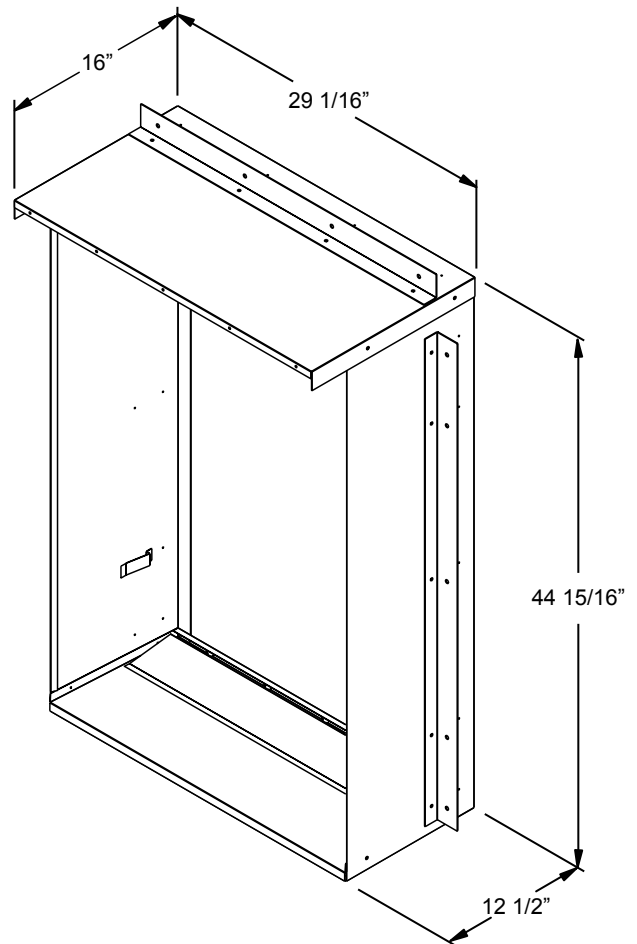

Actual wall sleeve sizes shown. Add 1/2" for opening size.

WALL SLEEVE ADAPTER PARTS IDENTIFICATION LIST

ITEM	DESCRIPTION	PART NO.	QUANTITY
1	Front Panel	14256135	1
2	Rear Panel	14256134	1
3	Left Panel	14256136	1
4	Right Panel	14256137	1
5	Side Panel Angle	14256139	2
6	#10 x 1/2 Hex Screw	14295007	12
7	1/2" Thick Insulation	14231002	1

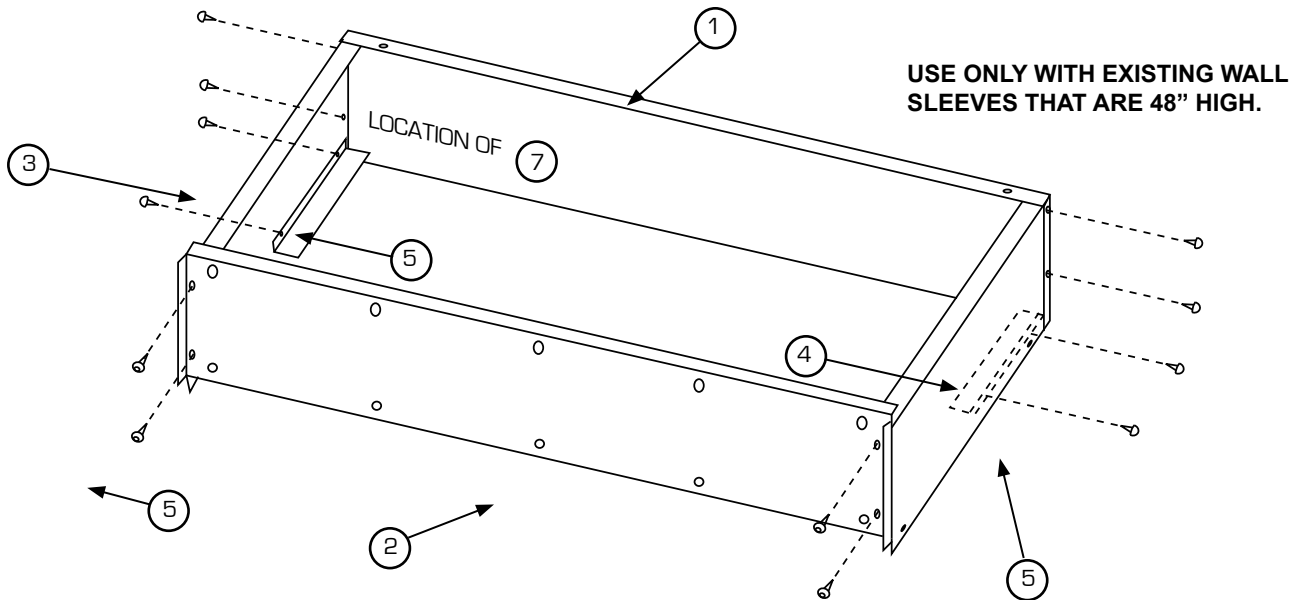

Assembly Instructions

CAUTION: ALWAYS WEAR SAFETY GLASSES WHEN WORKING WITH TOOLS! OVER-TIGHTENING THE SCREWS MAY STRIP THE RETAINING HOLES. READ ALL OF THE ASSEMBLY INSTRUCTIONS STEPS BEFORE PROCEEDING.

1. Identify ALL of the parts shown in the parts list. If any parts are missing, notify the factory for replacement(s).
2. Position the side panel angle (5) inside the left panel (3) in the position shown and secure with two screws (6).
3. Position the side panel angle (5) inside the right panel (4) in the position shown and secure with two screws (6).
4. Position the right panel (4) with the slots down inside the right end of the insulated side of the front panel (1) as shown and secure with two screws (6).
5. Position the left panel (3) with the slots down inside the left end of the insulated side of the front panel (1) as shown and secure with two screws (6).
6. Position the rear panel (2) with the five elongated holes on top as shown and attach it to the left panel (3) and right panel (4) with four screws (6).
7. On the Comfort Pack unit, remove two screws from the left side of the top panel flange starting at the front (outside). Also remove two screws from the right side of the top panel flange starting at the front (outside).
8. Position the Wall Sleeve Adapter on top of the Comfort Pack unit so that the bottom flanges on the front (outside) and both side panels go over the edges of the top of the unit. The rear panel of the Wall Sleeve Adapter should be on the outside surface of the top angle on the Comfort Pack unit.
9. Secure the Wall Sleeve Adapter to the Comfort Pack unit by installing the screws removed from the top panel in **Step 7** through the slotted holes in side panels of the Wall Sleeve Adapter into the top panel of the unit.
10. Using the enclosed 5/16" bolts, flat washers and nuts, install one washer on each bolt and insert the bolt through the top angle of the Comfort Pack unit into the Wall Sleeve Adapter. Install one nut per bolt on the inside of the Wall Sleeve Adapter and tighten the five bolts.
11. Install the Comfort Pack with Wall Sleeve Adapter into the Wall Sleeve.

